

Technical drawing of a truncated cone. The top diameter is labeled  $\phi G_1$ . The bottom diameter is labeled  $\phi G_2$ . The height is labeled  $H$ . The drawing shows the cone's profile with a central vertical axis and a horizontal line at the top.

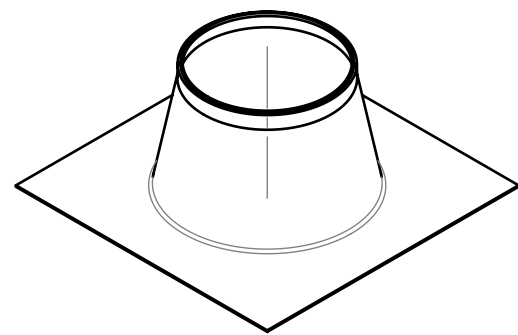

Technical drawing of a roof structure showing a cross-section of a trapezoidal roof with a central rectangular section. The drawing includes a dimension line labeled "Ø GG" indicating the width of the central section.

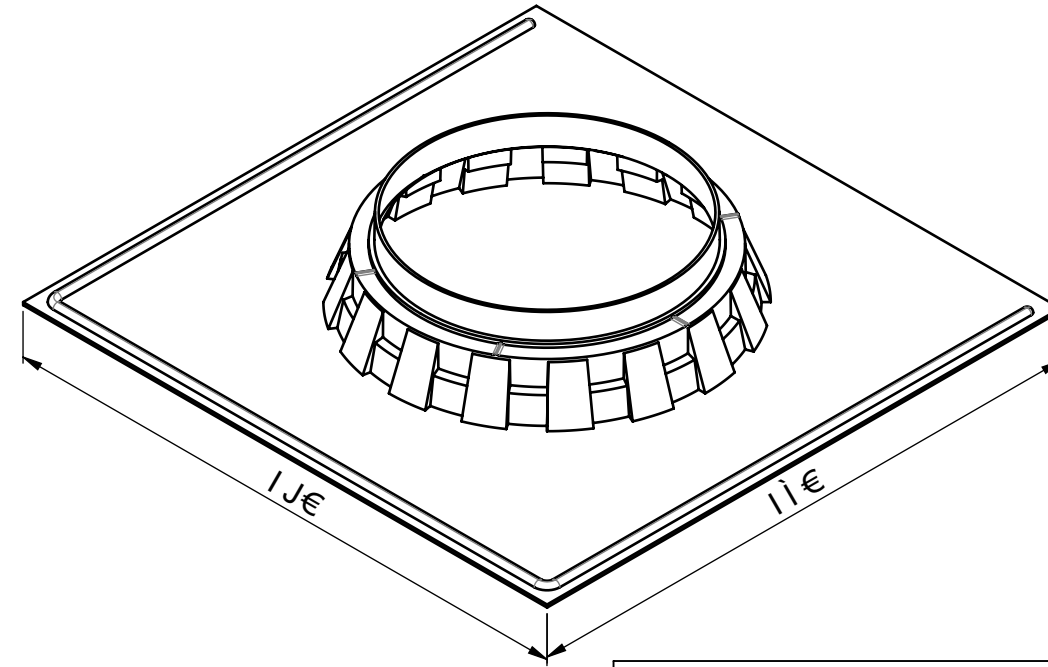

Technical drawing of a rectangular plate. The drawing shows a rectangle with a width dimension of  $\phi 66$  and a height dimension of  $100$ . There are four small squares representing mounting holes, one in each corner. The drawing is oriented vertically, with the width dimension at the top and the height dimension on the right side.

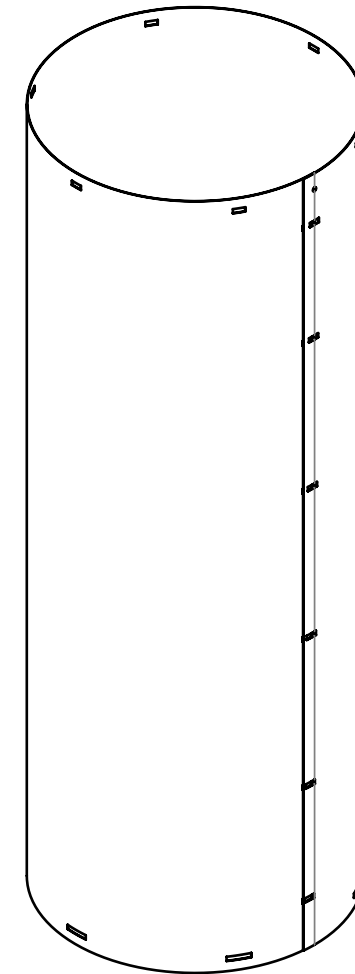
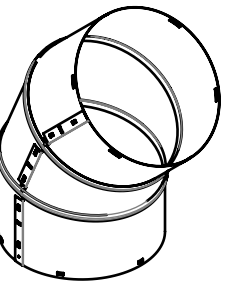
[illegible]

Technical drawing of a rectangular box. The vertical dimension is labeled  $FH$  and the horizontal dimension is labeled  $\varnothing FG$ . The drawing shows a perspective view of the box with a lid and a base. The lid has a small square in the top-left corner and a small rectangle in the top-right corner. The base has a small square in the bottom-left corner and a small rectangle in the bottom-right corner. The box is shown with a lid and a base, and the dimensions are indicated by arrows and labels.

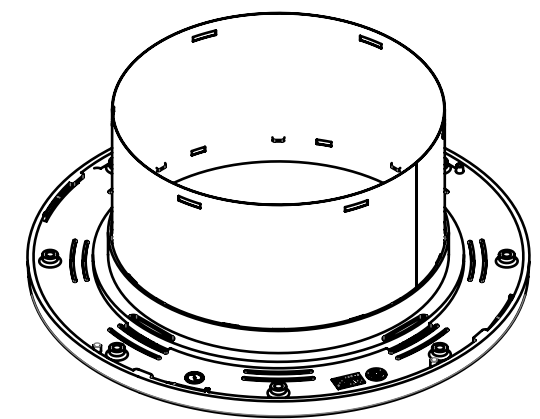

@ < HK 5 M  
7 F MGH5 @' \$\$ < D

